

WINTERBORNE WHITECHURCH		PROPOSALS MAP
		INSET No.
		59
		Policy Ref:
	Existing Distributor Route	Para. 1.32
	Regular Frequency Bus Route	Para. 1.32
	Settlement	1.7
	Important Open or Wooded Areas	1.9
	River Valley Area	1.12
	Ground Water Source Protection Area	1.16
	Conservation Area	1.24 - 27
	Ancient Monuments (AM) and Sites of Archaeological Importance	1.28 - 30
	Area of Outstanding Natural Beauty	1.32
Whole Inset Plan Area	Part Chalk River Valley & Part Chalk Uplands Landscape Character Areas	1.33

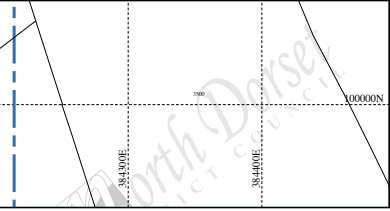

North Dorset DISTRICT COUNCIL
 Nordon, Salisbury Road, Blandford Forum, Dorset DT11 7LL
 Telephone (01258) 454111 • Fax (01258) 480179

NORTH DORSET DISTRICT - WIDE LOCAL PLAN (1st Revision)

This map is reproduced from Ordnance Survey material with the permission of The Controller H.M.S.O. © Crown Copyright reserved. North Dorset District Council LA 078778.

Scale **Adopted: Jan. 2003**